

EME.2705 | Horizontal Thermostatic Mixer with 3 Output Valve - 3/4"

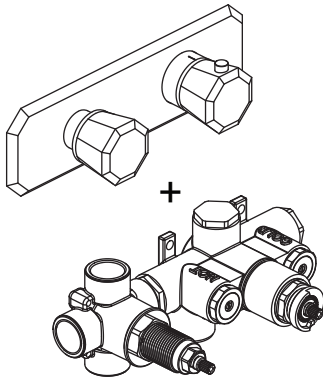

Trim [EME.2693T**]

Valve [JVH.2705F]

SPECIFICATIONS:

- Turn right knob to control temperature.
- Turn left knob to control water flow.
- Thermostatic Valve Flow Rate - 22LPM @ 3 BAR
- Extension Available - JVH.4101E**

Technical Diagram

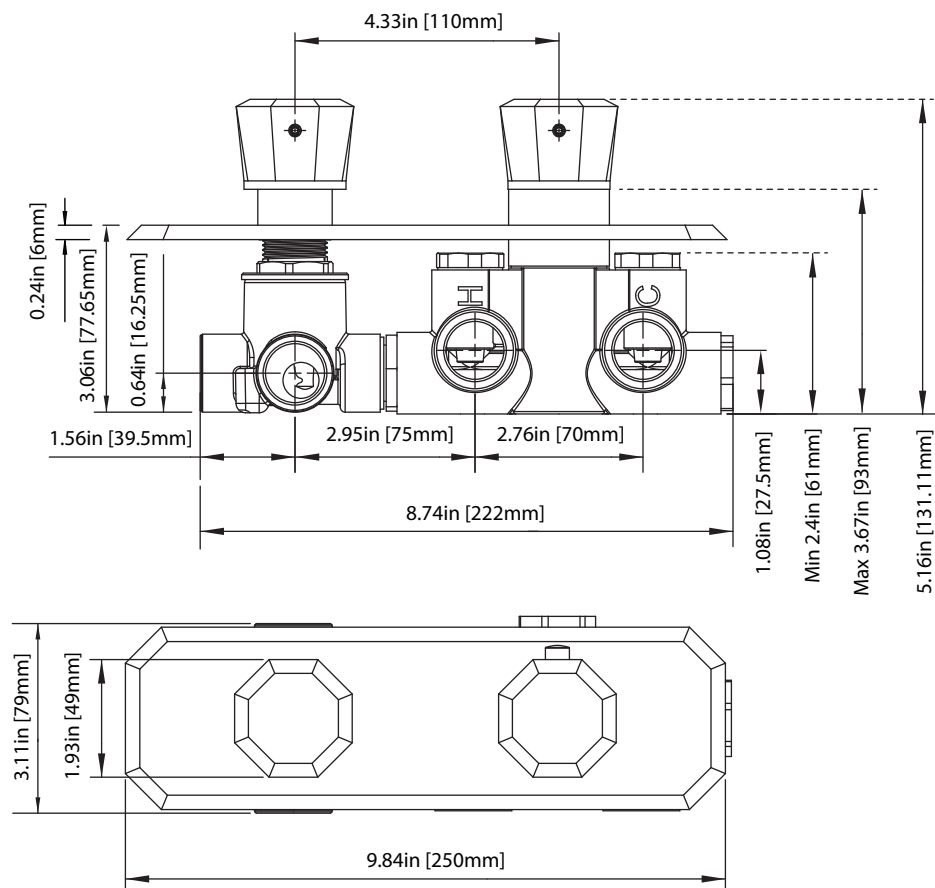

JVH.2705F | 3/4" Thermostatic Mixer Valve - 3 Output

Page 1 of 2

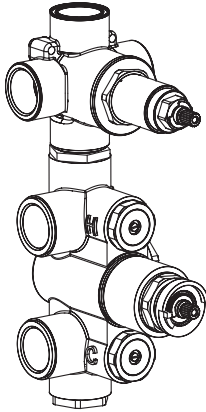

SPECIFICATIONS:

- Turn bottom knob to control temperature.
- Turn top knob to control water flow.
- Horizontal or Vertical install compatible.
- Thermostatic Valve Flow Rate - 22 LPM @ 3 BAR
- Extension Available - JVH.4101E**



A separate volume control is **not** needed to turn water supply off. Volume control functionality is integrated within this valve.

Technical Diagram

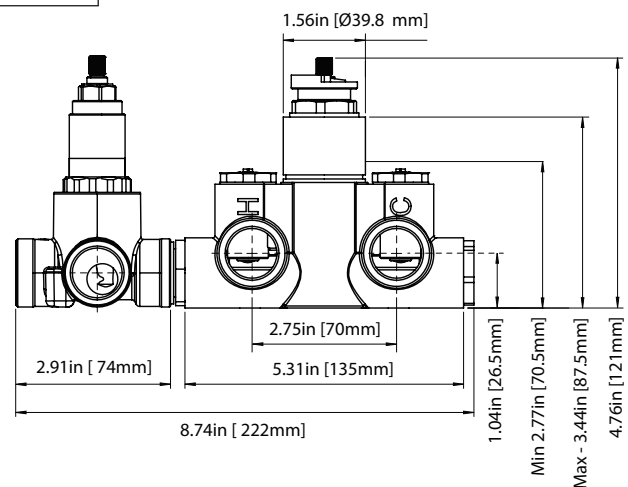
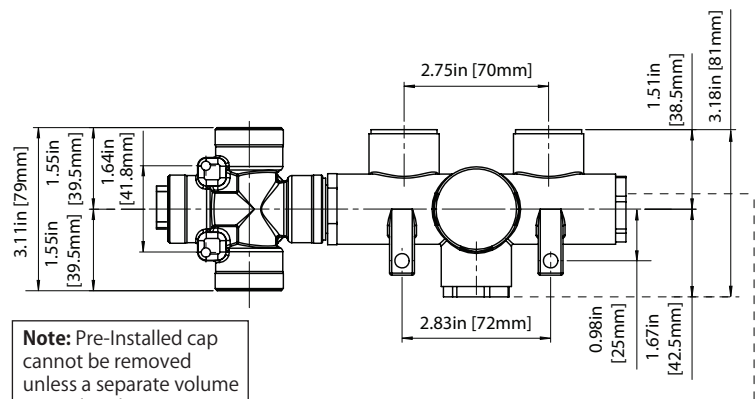
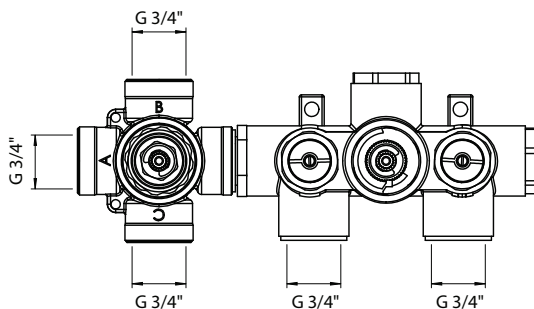

JVH.2705F | 3/4" Thermostatic Mixer Valve - 3 Output Page 1 of 2

THREE OUPTUT - NO SHARED PORT OPERATION

Diverter Cartridge # - **15100** (Included)

Total 6 Positions as defined below, with **only** 1 port active at one time.

- Position 0 - Off - No Water Flow
- Position 1 - Output B Activated
- Position 2 - Off - No Water Flow
- Position 3 - Output A Activated
- Position 4 - Off - No Water Flow
- Position 5 - Output C Activated

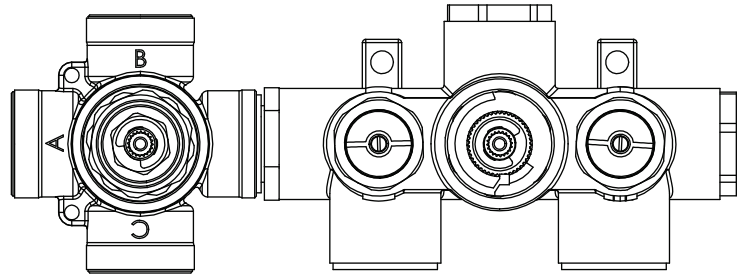

THREE OUPTUT - SHARED PORT OPERATION

Diverter Cartridge # - **15200** (Not Included)

Total 6 Positions as defined below, with 2 ports active at one time.

- Position 0 - Off - No Water Flow
 - Position 1 - Output B Activated
 - Position 2 - Output B+A Activated
 - Position 3 - Output A Activated
 - Position 4 - Output C+A Activated
 - Position 5 - Output C Activated
-