

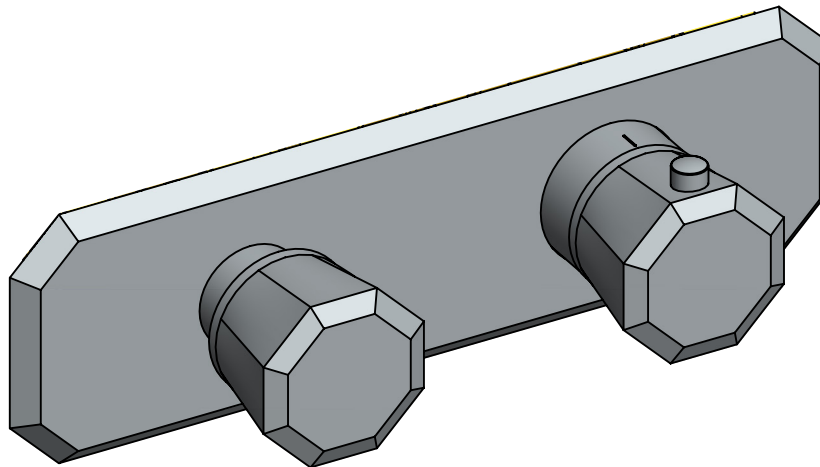

# Installation Manual - 230.2693T

## 3/4" Thermostatic Valve Trim

**Use With TVH.2693, TVH.2717F & TVH.2705F Valves**



### **BEFORE YOU BEGIN**

- You must observe all local plumbing laws and codes.
- Do not install this valve if it does not meet local plumbing codes.
- Shut off the main water supply.

## TABLE OF CONTENTS

- Installing The Trim . . . . . 1

## NOTICE TO HOMEOWNER

- We recommend that this product is installed by a qualified professional plumber.
- Please check this product immediately to ensure that it has not been damaged and is complete. Before installation, please make sure this product is the correct model and you have all the parts required for installation and use.
- Please flush the water system to ensure that no metal swarf, solder, and other impurities can enter the product.
- Turn off water supply before commencing work.
- Please read these instructions carefully and retain for future reference.

**INSTALLING THE TRIM - TRIM PLATE SIZE AND SHAPE MAY VARY - ILLUSTRATION ONLY**

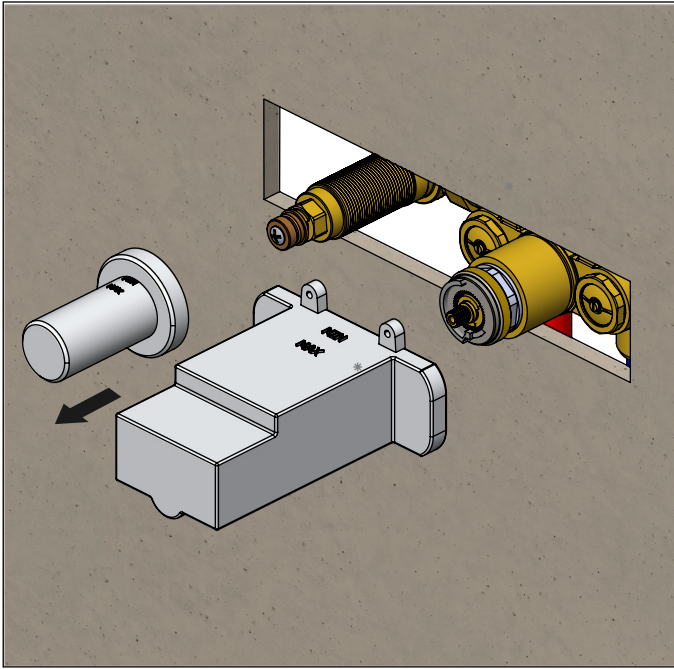

Remove mud guards

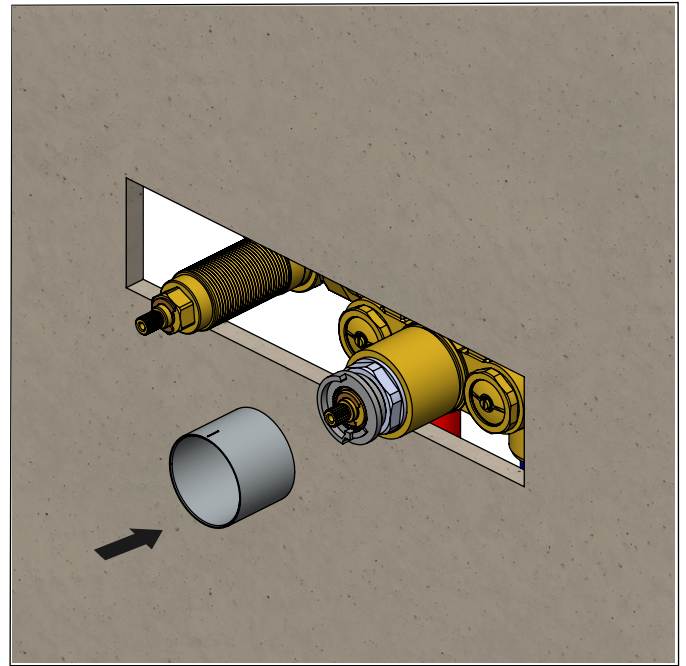

Install 42mm ring

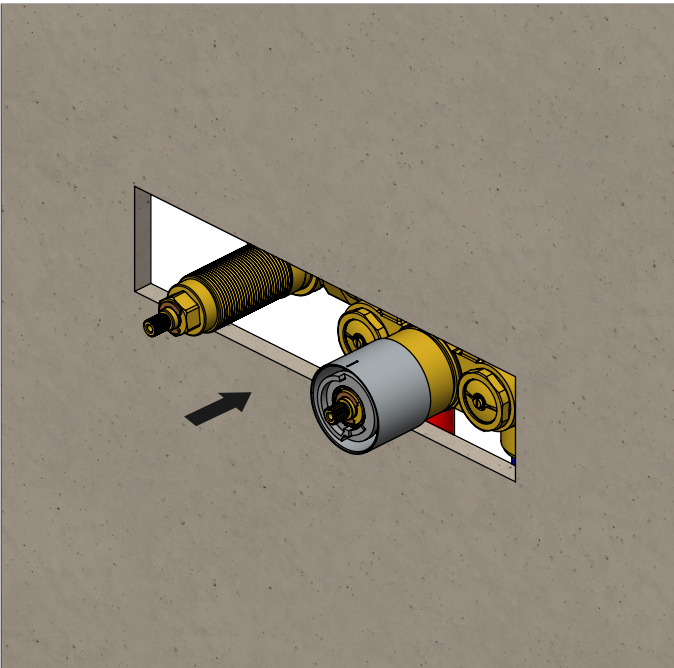

A hard push may be required

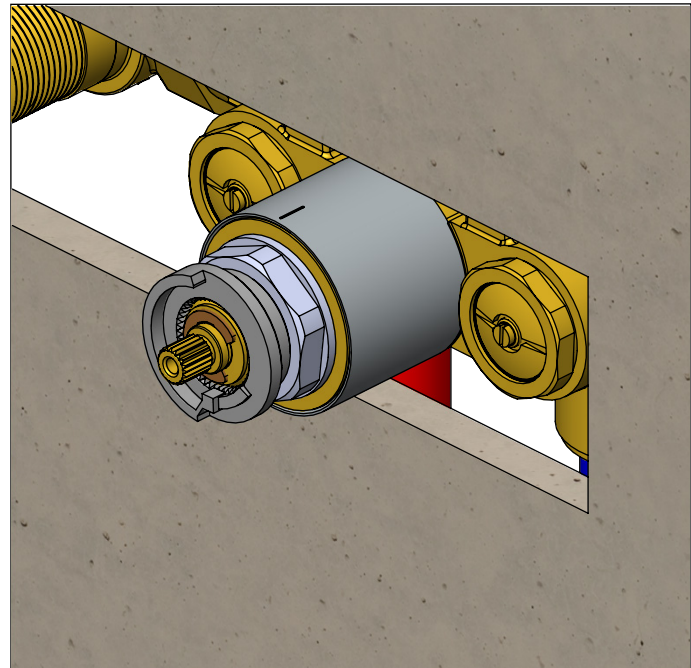

The 42mm ring must be flush. Otherwise the handle will not fit properly

**INSTALLING THE TRIM - TRIM PLATE SIZE AND SHAPE MAY VARY - ILLUSTRATION ONLY**

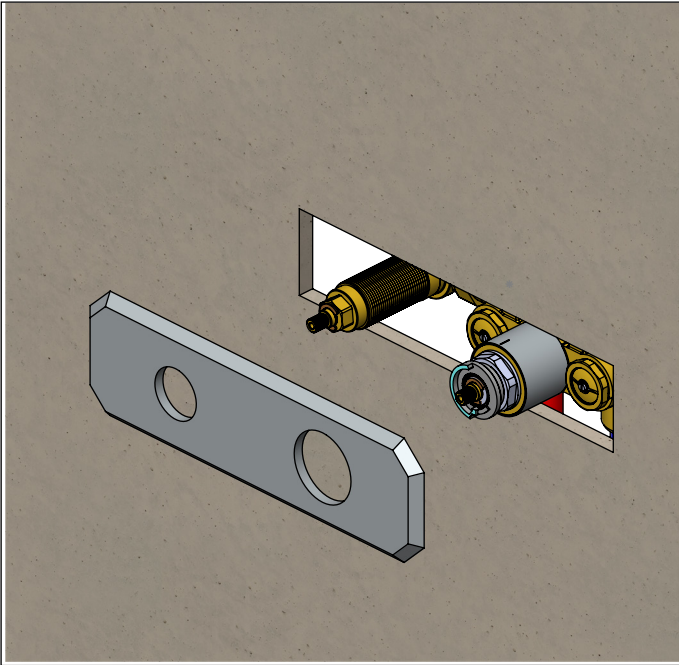

Insert trim plate

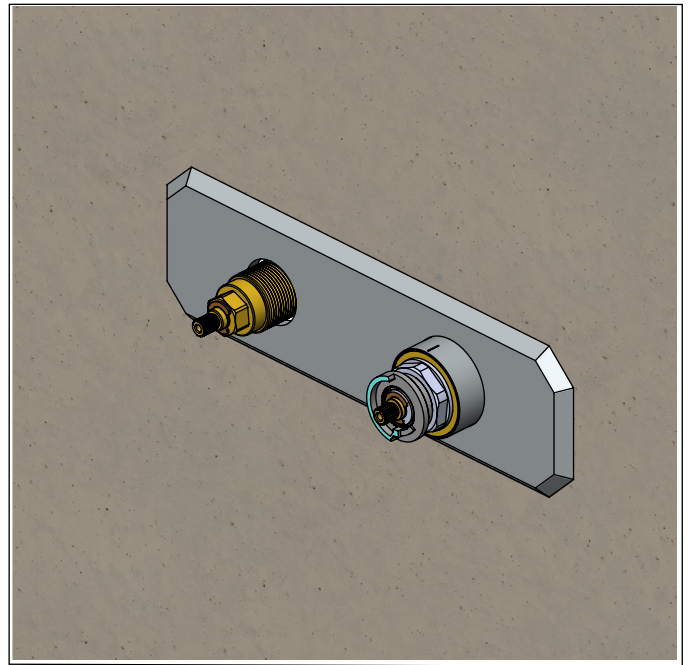

Align Trim plate till it is straight

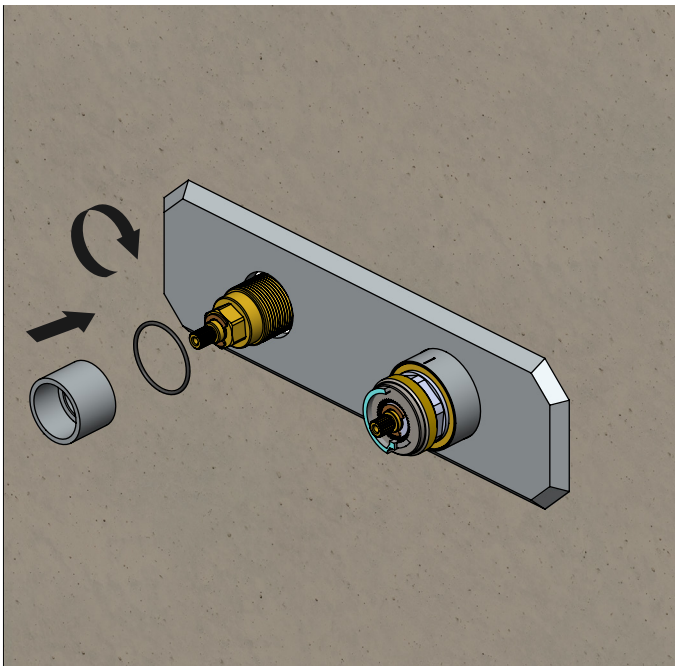

Insert adapter base and tighten

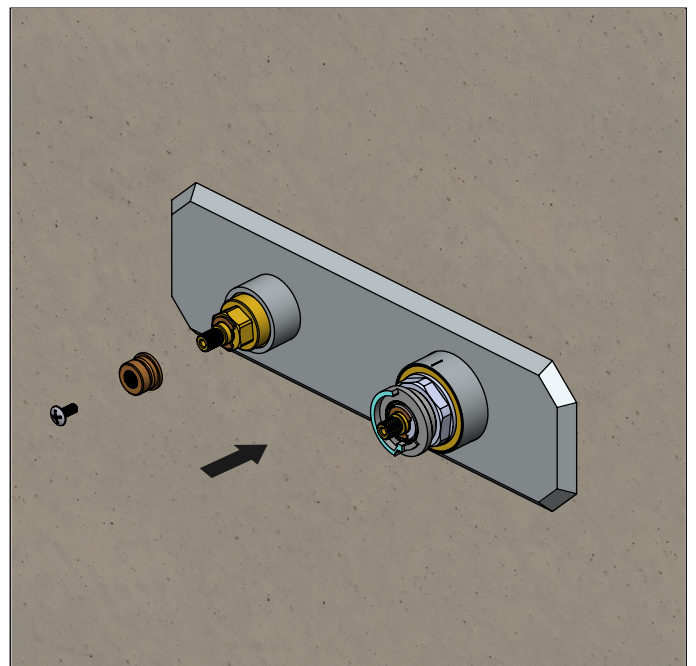

Insert centering knob & screws



**INSTALLING THE TRIM - TRIM PLATE SIZE AND SHAPE MAY VARY - ILLUSTRATION ONLY**

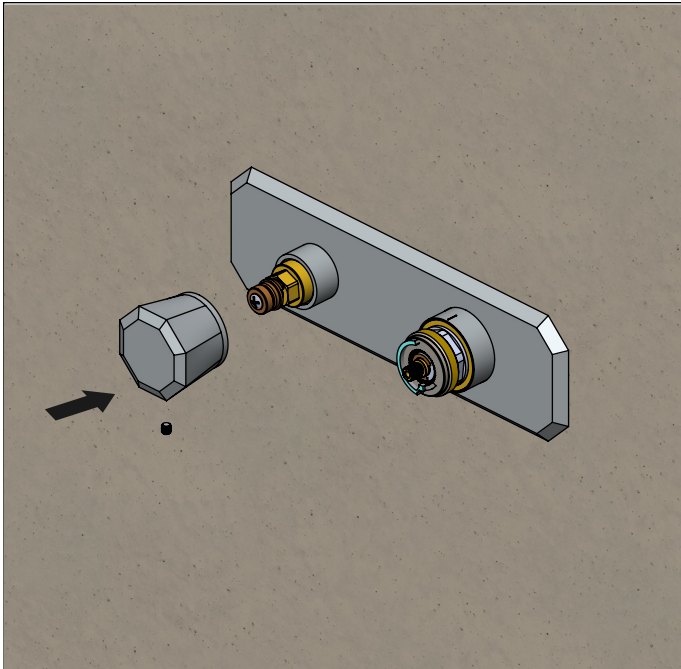

Insert volume handle. Tighten hex screw & insert cover button

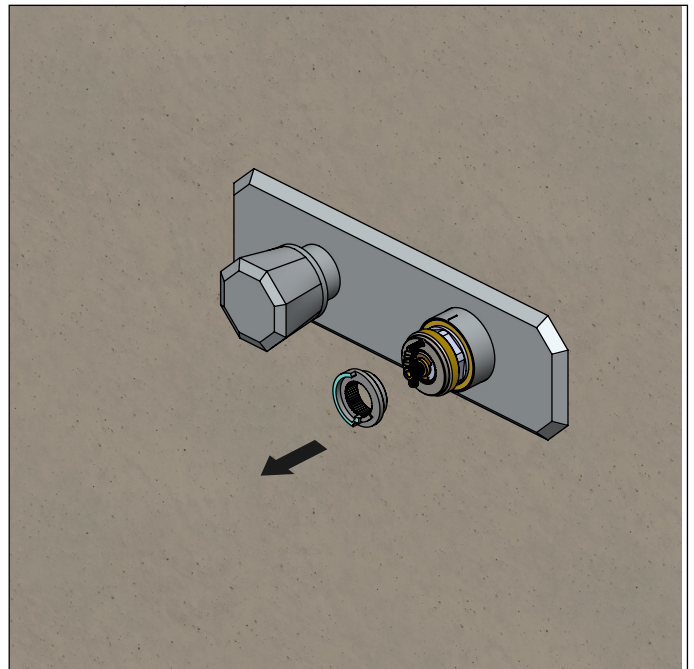

Remove anti-scald temperature ring and reinsert in correct position - see next image

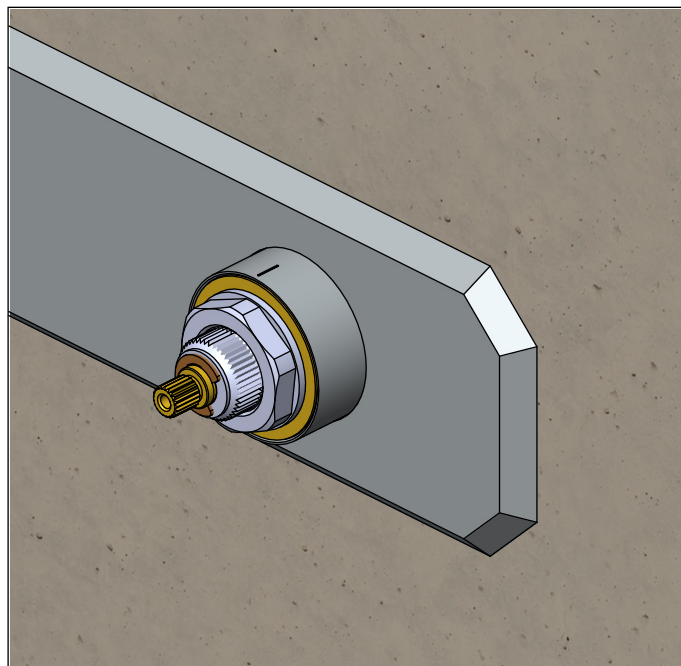

Calibrate cartridge before inserting temperature handle. Red marks must align.

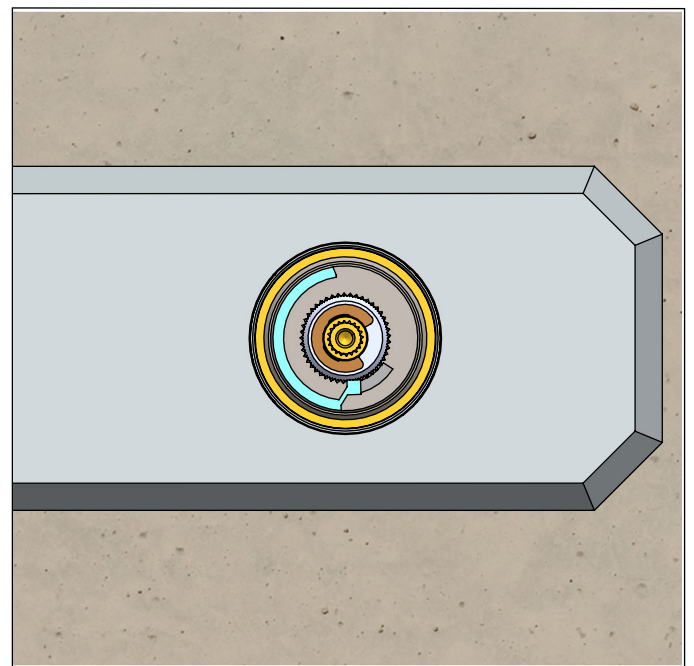

Correctly re-insert anti-scald temperature ring in the right position

**INSTALLING THE TRIM - TRIM PLATE SIZE AND SHAPE MAY VARY - ILLUSTRATION ONLY**

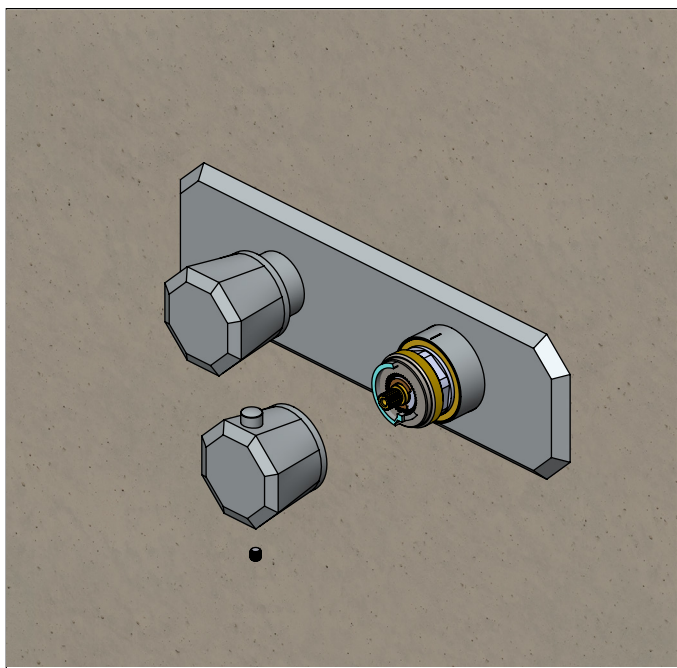

Insert temperature handle. Tighten hex screw & insert cover button

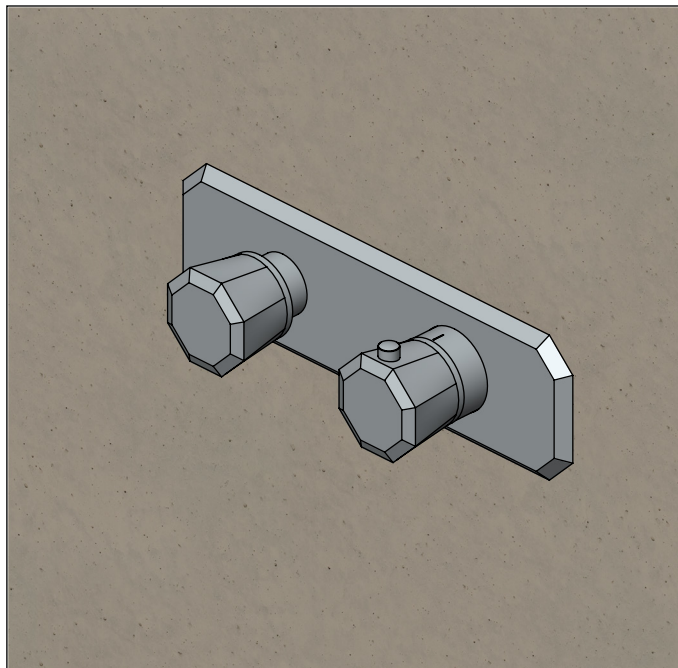

This photo shows a completely installed trim